

SETUP & OPERATION MANUAL

FEATURES

- Totally enclosed, fan cooled, permanently lubricated motor. Designed for industrial applications with a continuous duty rating.
- Heavy-duty construction, mounted on four swivel casters, allowing total mobility and stability.
- Safety switch with key. Unit cannot be started when key is removed from the switch.
- Precision spin-balanced impeller for smooth operation and minimal noise.
- Re-usable clear plastic collector bag for improved dust collection efficiency.
- 5" heavy-duty PVC hose between body of fan and collector.
- Collector body mounted on 3 heavy-duty rods.
- Equipped with 2 micron filter bag. (Not included on "CF" canister filter model)
- Quick-release bag clamps with metal straps.
- Intake screen prevents larger pieces from jamming in the impeller.

SPECIFICATIONS

INLET DIAMETERS

(1) 6" (152 mm)

Y FITTING INLET

(2) 4" (102 mm)

AIRFLOW CAPACITY

1250 CFM

BLOWER WHEEL DIAMETER

12 3/4" (323 mm)

SOUND RATING

80 TO 85 dB

BAG DIAMETER

20" (508 mm)

BAG CAPACITY

42 GAL (190.9 L)

STATIC PRESSURE

9" OF WATER

MOTOR

1 1/2 HP, 110 V, 1 Ph, 14 A

OVERALL DIMENSIONS (L x W x H)

36 1/4" x 22 3/4" x 22 3/4"

(920 x 580 x 580 mm)

WEIGHT

90 LBS (41 Kg)

110 LBS (50 Kg)

1 1/2 HP DUST COLLECTOR



MODEL

#10-105 MI

#10-105CF MI

#10-105 DAS MI

#10-105CF DAS MI

GENERAL



GENERAL® INTERNATIONAL

GENERAL INTERNATIONAL POWER PRODUCTS LLC
6243 Industrial Parkway | Whitehouse, Ohio 43571 (USA)

THANK YOU for choosing this General® International 10-105 M1 or 10-105CF M1 1 1/2 HP Dust Collector. This dust collector has been carefully tested and inspected before shipment and if properly used and maintained, will provide you with years of reliable service. For your safety, as well as to ensure optimum performance and trouble-free operation, and to get the most from your investment, please take the time to read this manual before assembling, installing and operating the unit.

The manual's purpose is to familiarize you with the safe operation, basic function, and features of this dust collector as well as the set-up, maintenance and identification of its parts and components. This manual is not intended as a substitute for formal woodworking instruction, nor to offer the user instruction in the craft of woodworking. If you are not sure about the safety of performing a certain operation or procedure, do not proceed until you can confirm, from knowledgeable and qualified sources, that it is safe to do so.

Once you've read through these instructions, keep this manual handy for future reference.

Disclaimer: The information and specifications in this manual pertain to the unit as it was supplied from the factory at the time of printing. Because we are committed to making constant improvements, General® International reserves the right to make changes to components, parts or features of this unit as deemed necessary, without prior notice and without obligation to install any such changes on previously delivered units. Reasonable care is taken at the factory to ensure that the specifications and information in this manual

corresponds with that of the unit with which it was supplied. However, special orders and "after factory" modifications may render some or all information in this manual inapplicable to your machine. Further, as several generations of this model of dust collector and several versions of this manual may be in circulation, if you own an earlier or later version of this unit, this manual may not depict your dust collector exactly. If you have any doubts or questions contact your retailer or our support line with the model number of your unit for clarification.

WARRANTY STATEMENT AND POLICY

Commercial General™ (Green Line) & Excalibur™ (Black Line) branded products:

3 -YEAR LIMITED WARRANTY All products are warranted for a period of 3 years (36 months) from the date of purchase. General™ agrees to repair or replace any part or component which upon examination, proves to be defective in either workmanship or material or parts and labor to the original purchaser during this 3-year warranty period, subject to the “conditions and exceptions” as listed below. Repairs made without the written consent of General will void the warranty

EXTEND YOUR WARRANTY:

Register your new General™ or Excalibur™ within 60 days of your purchase and get an extended 2 years, for a total of 5 years, of warranty coverage.

Go to www.general.ca/warranty/registration

DISCLAIMER:

Because we are committed to making constant improvements, General™ reserves the right to make changes to components, parts or features of this unit as deemed necessary, without prior notice and without obligation to install any such changes on previously delivered units. Reasonable care is taken at the factory to ensure that the specifications and information in this manual corresponds with that of the unit with which it was supplied.

TO FILE A CLAIM:

To file a claim under our Standard 3 -year Limited Warranty, all defective parts, components or machinery must be returned freight or postage prepaid to General™, or to a nearby distributor, repair center or other location designated by General™. For further details call our service department at 1-844-877-5234 or info@gipowerproducts.com. Along with the return of the product being claimed for warranty, a copy of the original proof of purchase and a “letter of claim” must be included (a warranty claim form can also be used and can be obtained, upon request, from General™ or an authorized distributor) clearly stating the model and serial number of the unit (if applicable) and including an explanation of the complaint or presumed defect in material or workmanship.

CONDITIONS AND EXCEPTIONS:

This coverage is extended to the original purchaser only. Prior warranty registration is not required but documented proof of purchase, i.e. a copy of original sales invoice or receipt showing the date and location of the purchase as well as the purchase price paid, must be provided at the time of claim. Warranty does not include failures, breakage or defects deemed after inspection by General™ to have been directly or indirectly caused by or resulting from; improper use, or lack of or improper maintenance, misuse or abuse, negligence, accidents, damage in handling or transport, or normal wear and tear of any generally considered consumable parts or components. Repairs made without the written consent of General™ will void all warranty. This five-year warranty does not cover products used for commercial, industrial or educational purposes. The warranty term for these claims will be limited to a two-year period.

Rules for Safe Operation

To help ensure safe operation, please take a moment to learn the machine's applications and limitations, as well as potential hazards. General® International disclaims any real or implied warranty and holds itself harmless for any injury that may result from improper use of its equipment.

1. Do not operate this machine without either a filter bag or filter cartridge properly installed on the unit.
2. Keep the work area well lit, clean and free of debris.
3. Do not handle the electrical plug with wet hands.
4. Do not use this unit outdoors or near wet surfaces.
5. Always turn on the dust collector before starting the dust producing machine. Always turn off the dust producing machine before turning off the dust collector.
6. Do not vacuum anything that is burning, smoking or smoldering such as cigarettes, matches or hot ashes.
7. Stay alert! Give your work your undivided attention. Even a momentary distraction can lead to serious injury.
8. Fine particulate dust is a carcinogen that can be hazardous to health. Work in well ventilated area and wear eye, ear and respiratory protection devices.
9. Do not wear loose clothing, gloves, bracelets, necklaces, or other jewelry.
10. Do not vacuum or use this dust collector near flammable or combustible liquids, gases, gasoline or other fuels, lighter fluid, cleaners, oil or solvent based paints, natural gas, hydrogen or explosive dusts like coal dust, magnesium dust, grain dust or gun powder.
11. Do not operate this dust collector when tired, distracted or under the effects of drugs, alcohol or any medication that impairs reflexes or alertness.
12. Do not operate the unit until a dust hose is installed onto the hose inlet.
13. Never leave the machine unattended while running or with the power on.
14. To avoid health hazards from vapors or dusts, do not vacuum toxic material.
15. Do not insert hands or fingers or any foreign objects into ventilation inlet and outlet openings.
16. Childproof and tamper proof your shop and all machinery with locks, master electrical switches and switch keys to prevent unauthorized or unsupervised use.
17. Keep children and visitors at a safe distance when the unit is running. Do not permit them to use the machine.
18. Use only recommended accessories. Use of accessories NOT recommended by General® International may result in a risk of injury or damage to the machine.
19. Make sure the unit is properly grounded. If equipped with three-prong plug, it should be plugged into a three-pole receptacle. Never remove the third-prong.
20. Always disconnect the unit from the power source before servicing, performing any maintenance or repairs and when changing bags or hoses, or if the machine will be left unattended.
21. Do not use this dust collector for any purpose other than it is intended use. If used for other purposes, GENERAL® INTERNATIONAL disclaims any real or implied warranty and holds itself harmless for any injury, which may result from that use.
22. Clean filters (bags on 10-105 or cartridges 10-105CF) on a regular basis and replace as needed.



ELECTRICAL REQUIREMENTS



BEFORE CONNECTING THE MACHINE TO THE POWER SOURCE, VERIFY THAT THE VOLTAGE OF YOUR POWER SUPPLY CORRESPONDS WITH THE VOLTAGE SPECIFIED ON THE MOTOR I.D. NAMEPLATE. A POWER SOURCE WITH GREATER VOLTAGE THAN NEEDED CAN RESULT IN SERIOUS INJURY TO THE USER AS WELL AS DAMAGE TO THE MACHINE. IF IN DOUBT, CONTACT A QUALIFIED ELECTRICIAN BEFORE CONNECTING TO THE POWER SOURCE.

THIS TOOL IS FOR INDOOR USE ONLY. DO NOT EXPOSE TO RAIN OR USE IN WET OR DAMP LOCATIONS.

GROUNDING INSTRUCTIONS

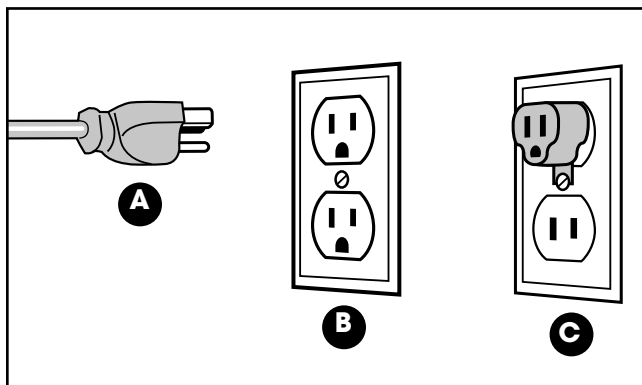

In the event of an electrical malfunction or short circuit, grounding reduces the risk of electric shock. The motor of this machine is wired for 110V single phase operation and is equipped with a 3-conductor cord and a 3-prong grounding plug **A** to fit a grounded type receptacle **B**. Do not remove the 3rd prong (grounding pin) to make it fit into an old 2-hole wall socket or extension cord. If an adaptor plug is used **C**, it must be attached to the metal screw of the receptacle.

Note: The use of an adaptor plug is illegal in some areas. Check your local codes. If you have any doubts or if the supplied plug does not correspond to your electrical outlet, consult a qualified electrician before proceeding.

CIRCUIT CAPACITY

Make sure that the wires in your circuit are capable of handling the amperage draw from your machine, as well as any other machines that could be operating on the same circuit. If you are unsure, consult a qualified electrician. If the circuit breaker trips or the fuse blows regularly, your machine may be operating on a circuit that is close to its amperage draw capacity. However, if an unusual amperage draw does not exist and a power failure still occurs, contact a qualified technician or our service department.

EXTENSION CORDS

If you find it necessary to use an extension cord with your machine, use only 3-wire extension cords that have 3-prong grounding plug and a matching 3-pole receptacle that accepts the tool's plug. Repair or replace a damaged extension cord or plug immediately.

Make sure the cord rating is suitable for the amperage listed on the motor I.D. plate. An undersized cord will cause a drop in line voltage resulting in loss of power and overheating. The accompanying chart shows the correct size extension cord to be used based on cord length and motor I.D. plate amp rating. If in doubt, use the next heavier gauge. The smaller the number, the heavier the gauge.

TABLE - MINIMUM GAUGE FOR CORD

AMPERE RATING	TOTAL LENGTH OF CORD IN FEET				
	110 VOLTS	25 FEET	50 FEET	100 FEET	150 FEET
	AWG				
< 5	----->	18	16	16	14
6 TO 10	----->	18	16	14	12
10 TO 12	----->	16	16	14	12
12 TO 16	----->	14	12	* NR	* NR

*** NR = Not Recommended**



1 1/2 HP DUST COLLECTOR

10-105 M1 or 10-105CF M1
10-105 DAS M1 or 10-105CF DAS M1

IDENTIFICATION OF MAIN PARTS AND COMPONENTS

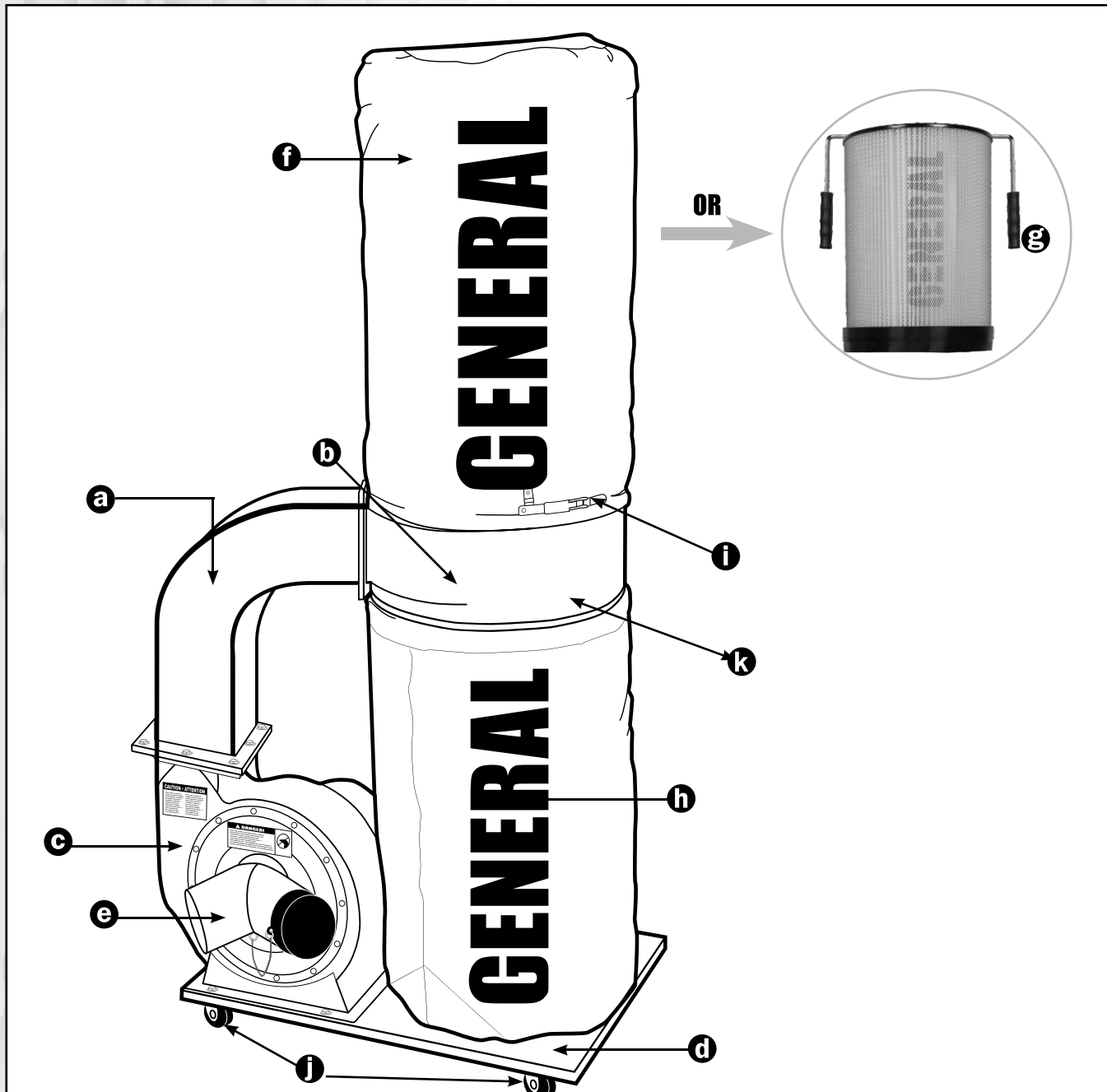

- | | |
|---------------------------------------|--------------------------|
| a CONNECTOR | g CANISTER FILTER |
| b DRUM | h COLLECTOR BAG |
| c COLLECTOR BODY W/MOTOR ASS'Y | i BELT CLAMP |
| d BASE PLATE | j CASTER (4X) |
| e HOSE INLET ("Y" FITTING) | k SNAP RING |
| f FILTER BAG | |

UNPACKING AND PREPARATION FOR SET-UP & ASSEMBLY

SAFETY



Use caution and wear gloves when handling metal parts such as the belt clamps, which can cut if handled carelessly.



The model 10-105 is a heavy machine (106 Lbs. shipping weight - 48 kg.) Do not overexert. Arrange to have help nearby and ready for unpacking and set up.



The sound level of this machine is rated at approximately 80 to 85 db during operation. Make sure that adequate hearing protection is used and that the overall sound level within the working environment is taken into consideration.

ADDITIONAL REQUIREMENTS FOR SET-UP & ASSEMBLY

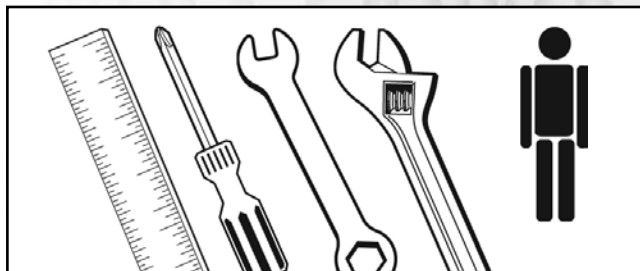

- Flat piece of wood (such as a ruler)
- Medium Phillips Screwdriver
- 10 & 12 mm open end wrench or adjustable wrench
- 1 extra person for help with lifting

UNPACKING

Carefully unpack and remove the unit and its components from its shipping container and check for missing or damaged items as per the list of contents below.

NOTE: Please report any damaged or missing items to your **GENERAL® INTERNATIONAL** distributor immediately.

LIST OF CONTENTS

	QTY
A- DRUM	1
B- COLLECTOR BODY & MOTOR ASSEMBLY	1
C- CONNECTOR	1
D- BASE PLATE	1
E- VERTICAL SUPPORT ROD	2
F- FILTER BAG	1
G- BAG HANGER	1
H- COLLECTOR BAG	1
I- BELT CLAMP	1
J- SNAP RING	1
K- RUBBER GASKET	2
L- HOSE INLET ("Y" FITTING).....	1

LIST OF CONTENTS

	QTY
M- CASTER.....	4
N- WRENCH	1
CROSS HEAD SCREW(3/16" X 1/2").....	17
HEX HEAD BOLT(5/16" X 1/2").....	16
HEX HEAD BOLT(5/16" X 2/3").....	12
STANDARD SPRING WASHE(3/16").....	16
FLAT WASHER(3/16").....	16
STANDARD SPRING WASHE(5/16").....	28
PLASTIC BAG.....	1
FLAT WASHER(5/16").....	28
O- CANISTER FILTER (FOR 10-105CF M1/10-110CF M1/10-210CF M1).....	1

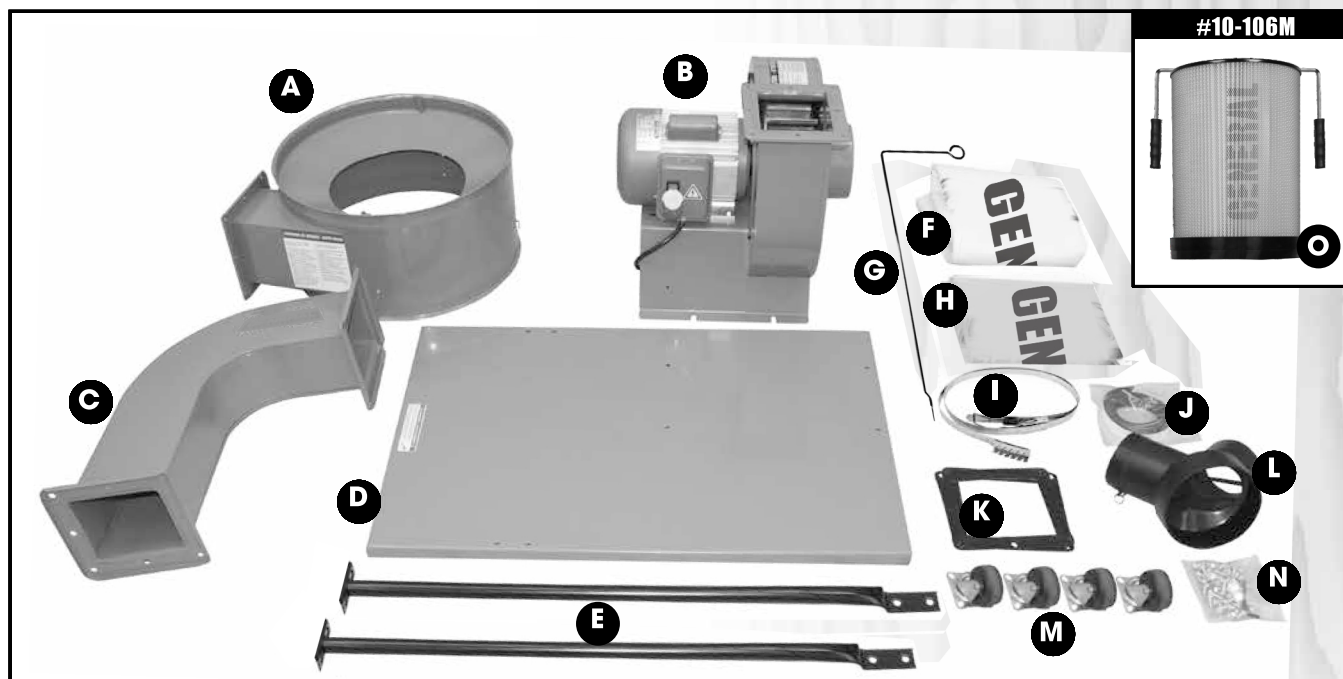

SHOP PLACEMENT / SPACE CONSIDERATIONS

Because each shop situation is unique, the following factors should be taken into consideration when determining and before deciding on the ideal installation to best suit your shop dust collection needs.

The unit should be installed as close to the dust source(s) as possible.

The base of the unit is mounted on casters and as such the dust collector can be moved from one location to another within the shop if a permanent installation location is not practical or desired.

In all cases the unit should be installed on a flat, sturdy and stable surface that is able to support the weight of the unit as well as the weight of the operator. The casters should be blocked to prevent the unit from moving when it is in use.

Consider the space requirements for the unit and its use when deciding where to install your dust collector in your shop.

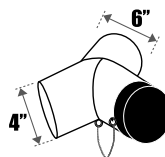
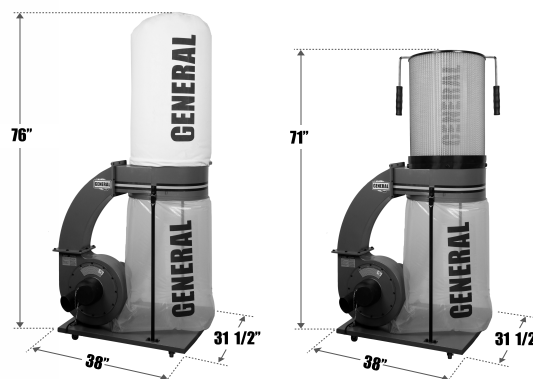

The dust collector is equipped with a 6" main hose inlet that is fitted with a dual-inlet "Y" fitting allowing you to connect up to two 4" dust hoses.

LAYING OUT A PLAN FOR THE PIPING

For permanent installations it is advisable to map out a rough layout of your planned installation starting from the dust collector out to all the machines that you wish to connect to the system. You may vary your layout to suit your specific shop needs and may choose to use metal or plastic ducting, or flexible hose in any combination as suited to your needs.

Note: To avoid accidents as well as damage to ducting or hoses, plan your installation with hoses and ducting running along walls or mounted from above wherever possible. See the accompanying examples of non-recommended and recommended installations.

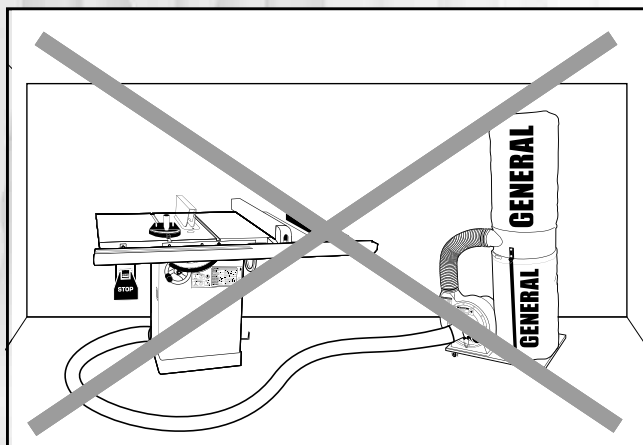

Wherever possible avoid running hoses and ducting along the floor.

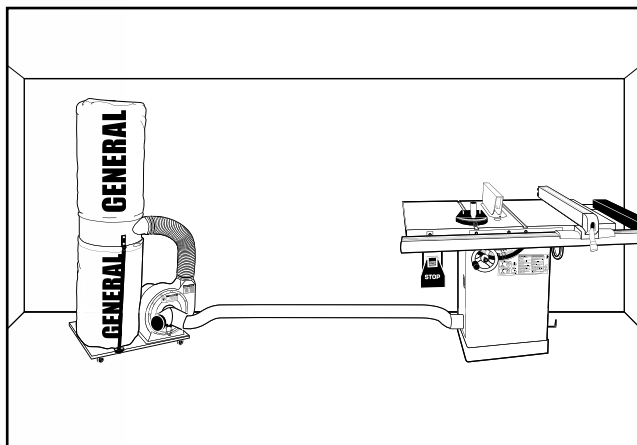

Keep hoses and ducting safely mounted along the walls.



HOSES AND DUCTING RUNNING ALONG THE SHOP FLOOR BETWEEN MACHINERY CAN CAUSE USERS TO TRIP AND LEAD TO SERIOUS INJURY.

ASSEMBLY INSTRUCTIONS



- **SERIOUS PERSONAL INJURY COULD OCCUR IF YOU CONNECT THE MACHINE TO THE POWER SOURCE BEFORE YOUR HAVE COMPLETED THE SET UP PROCESS. DO NOT HOOK-UP THE MACHINE TO A POWER SOURCE UNTIL INSTRUCTED TO DO SO.**
- **BE SURE TO READ AND UNDERSTAND THIS ENTIRE MANUAL.**
- **USE CAUTION AND WEAR GLOVES WHEN HANDLING METAL PARTS SUCH AS THE BELT CLAMPS, WHICH CAN CUT IF HANDLED CARELESSLY.**
- **THE SOUND LEVEL OF THIS MACHINE IS RATED AT APPROXIMATELY 80-85 DB DURING OPERATION. MAKE SURE THAT ADEQUATE HEARING PROTECTION IS USED AND THAT THE OVERALL SOUND LEVEL WITHIN THE WORKING ENVIRONMENT IS TAKEN INTO CONSIDERATION.**

STEP 1 - INSTALL THE CASTERS

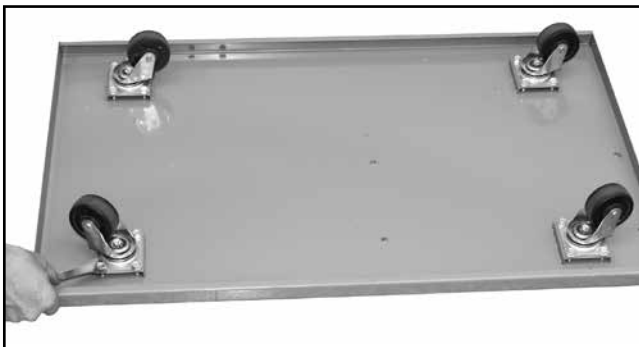

Turn the base plate upside down and using the supplied wrench, attach the 4 casters.
Hard ware bag # 1

STEP 2 - ATTACH COLLECTOR BODY W/ MOTOR ASSEMBLY

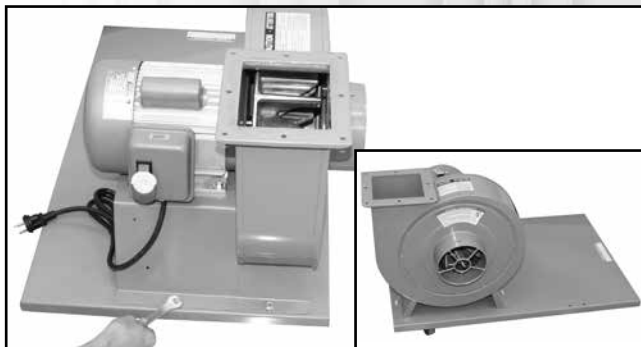

Turn the base plate back over (right side up) and place the collector body with motor assembly on it lining up the mounting holes.
Hard ware bag # 2

STEP 3 - ATTACH THE CONNECTOR

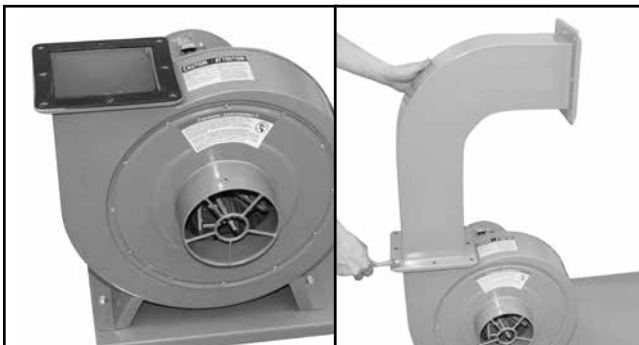

Place one of the rubber gaskets over the opening of the collector body. Take the connector and proceed by placing it over the same opening.
Hard ware bag # 3

STEP 4 - ATTACH THE DRUM

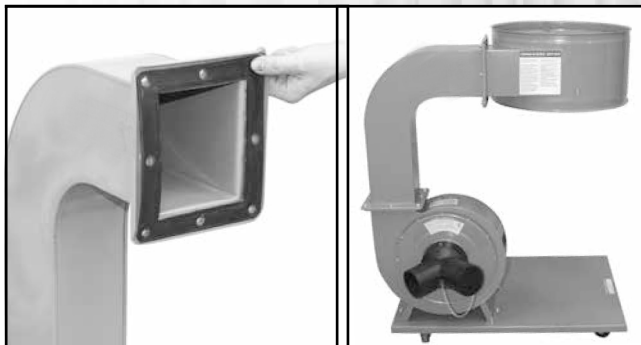

Use the remaining rubber gasket and place it over the opening of the connector. Take the drum and proceed by placing it over the same opening.
Hard ware bag # 3

STEP 5 - MOUNT THE SUPPORT ROD TO THE BASE

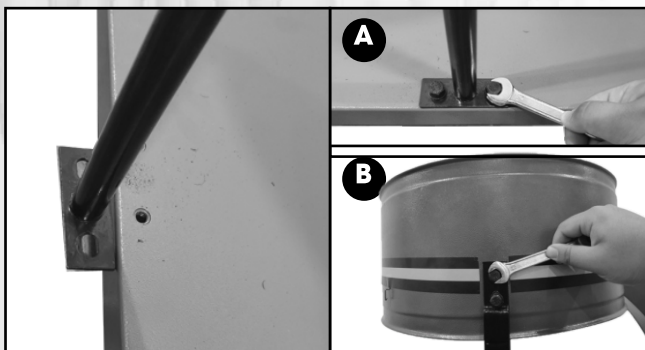

Attach the vertical support rods to the rear of the base plate and to the drum, **B**.

STEP 7 - INSTALL THE COLLECTOR BAG



1. Place the snap ring over the top of the plastic bag and fold the bag over the ring approximately three inches, **D**.
2. Insert the snap ring **E** of the collector bag into the bottom of the housing at an angle.
3. Pull down on the snap ring to make sure it seats in the housing.

Note: Make sure the snap ring "snaps" into place in the housing, and also that the plastic bag hangs down approximately 3 inches so that there are no air leaks.

STEP 6 - INSTALL THE HOSE INLET ("Y" FITTING)

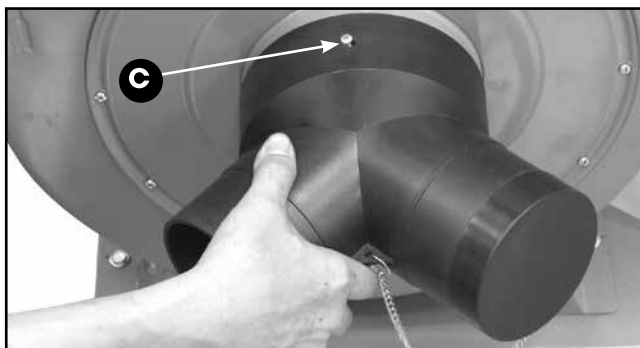

Install the hose fitting ("Y" fitting) to the front of the collector body with a pan head screw **C**.

STEP 8 - INSTALL THE BAG HANGER ONTO THE DRUM

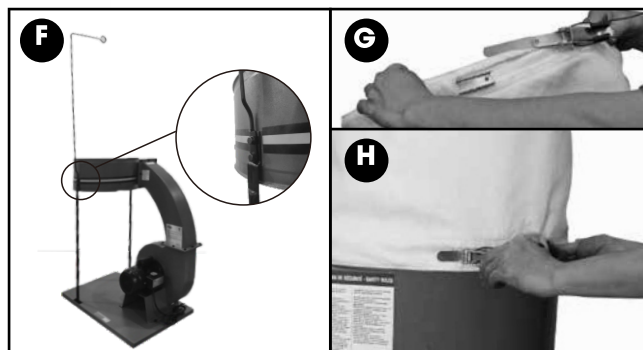

If you have model 10-110CF M1 (with canister filter) skip ahead to step #9.

Fit the upper bag support into the holes on the drum **F**. Slip a belt clamp through the opening in the filter bag until it comes out through the hole at the other end **G**. Use the belt clamp to attach the filter bag to the upper portion of the drum **H**. Before tightening the clamp make sure the metal strap is sitting in the groove on the upper portion of the drum to create an airtight seal between the drum and the bag.

OPERATING INSTRUCTIONS



ALWAYS TURN ON THE DUST COLLECTOR BEFORE STARTING YOUR DUST PRODUCING MACHINE AND ALWAYS STOP THE DUST PRODUCING MACHINE BEFORE TURNING OFF THE DUST COLLECTOR.

BEFORE STARTING

1. To minimize airborne dust make sure that all hoses, fittings and clamps are secure and airtight.
2. For maximum system efficiency, make sure a cover is installed on any unused hose inlet openings, .
3. Never operate the machine without the filter bag or canister and the collection bag properly installed.



THE SOUND LEVEL OF THIS MACHINE IS RATED AT APPROXIMATELY 80-85 DB DURING OPERATION. MAKE SURE THAT ADEQUATE HEARING PROTECTION IS USED AND THAT THE OVERALL SOUND LEVEL WITHIN THE WORKING ENVIRONMENT IS TAKEN INTO CONSIDERATION.

BASIC INSTRUCTIONS

The Dust Collector has been designed to capture, remove, and collect non-metallic dust and wood dust around the workshop and from woodworking machinery.

#10-105 M1 #10-105CF M1

ON/OFF SWITCH

The model 10-105 M1 & 10-105CF M1 are equipped with a simple “rocker style” On/Off switch featuring a removable lock out safety key.

To prevent unauthorized use or unintentional start-up, remove the safety key and store it in a safe place whenever the dust collector is not in use.

To start the dust collector, insert the safety key and pull up the switch. To stop the machine, push down on the power switch.

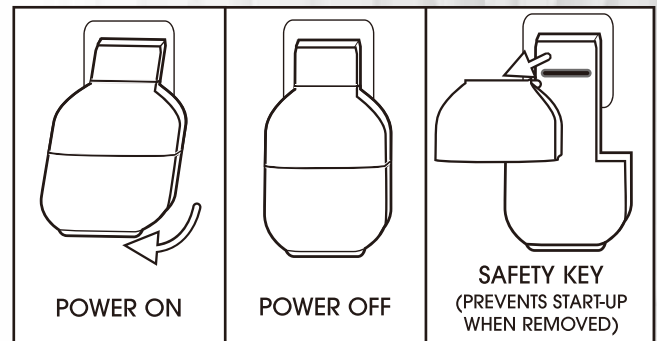

#10-105 DAS M1 #10-105CF DAS M1

Operation steps of DAS Dust Collector:

1. Plug the Dust Collector into your power source, wall outlet.
2. Plug intended machine to be used into the plug on the DAS Dust collector.
3. Press switch on left side to put in DAS mode.
4. Turn on intended machine of use that you have plugged into the DAS Dust Collector and as soon as you turn on this machine, the Dust Collector will turn on and start collecting dust.
5. To stop, turn off the machine you were using and the DAS Dust Collector will turn off AUTOMATICALLY within eight (8) seconds after you turned off the machine you were using.

Operation steps in manual mode:

Press switch to the right, this will turn unit ON.

To turn OFF, push switch to left so that the switch is level on both sides.



MAKE SURE THE SWITCH IS IN THE “OFF” POSITION BEFORE PLUGGING IN THE POWER CORD.

REMOVE THE SWITCH KEY WHENEVER THE DUST COLLECTOR IS NOT IN USE. PLACE IT IN A SAFE PLACE AND OUT OF THE REACH OF CHILDREN.

MAINTENANCE & SERVICING



MAKE SURE THE SWITCH IS IN THE "OFF" POSITION AND UNPLUG THE UNIT FROM THE POWER SOURCE BEFORE PERFORMING ANY MAINTENANCE.

This machine operates on **110 V**; if you suspect any electrical problems call a qualified electrician to do the verification of the electrical circuit or the machine. If you need further help with your dust collector contact your **General® International** distributor or our **Technical Service Department @ 888-664-0449**.

- All bearings are sealed and permanently lubricated. No further lubrication is needed.
- Periodically inspect all hardware, fittings and fasteners that may have loosened due to vibration - re-tighten as needed.
- To minimize airborne dust particles periodically inspect all dust collection fittings. Re-tighten as needed.
- Keep the outside of the unit clean and wipe off excessive dust or dirt with a dry rag.
- Clean filters on a regular basis and replace as needed.
- Periodically inspect inside of all pipes, fittings, hoses, blast gates, and connectors for accumulated dust build-up or other obstructions, and clean as needed. Remove sections and vacuum or manually remove debris as needed.
- Check and if necessary replace all damaged parts or components.
- Do not operate with a damaged filter bag or canister filter - replace a damaged filter immediately.
- Periodically inspect the power cord and plug for damage. If necessary replace the power cord and plug at the first signs of visible damage.
- Use only recommended parts and accessories. The use of parts or accessories NOT recommended by **GENERAL® INTERNATIONAL** may result in a risk of injury or damage to the machine.

CLEANING OR REPLACING THE FILTER BAGS



TURN THE SWITCH TO THE "OFF" POSITION AND UNPLUG THE UNIT FROM THE POWER SOURCE BEFORE CLEANING OR REPLACING FILTER BAGS OR BEFORE PERFORMING ANY MAINTENANCE.

Tip/Hint: To avoid potentially costly down-time, consider keeping a spare filter bag on-hand and nearby for use if needed.

After a period of time depending on the frequency of use, the filter bag may become clogged and affect airflow as well the overall efficiency of the unit. Should you notice a drop in the efficiency or performance of the unit, it may be a sign that it is time to clean the filter bag. If so, proceed as follows:

1. Turn off and unplug the machine.
2. Unclip the belt clamp and remove the bag from the machine.
3. Clean the dust from inside the filter bag using a vacuum.
4. For extreme cases, after the initial cleaning with a vacuum, turn filter bag inside out and vacuum a second time, laying the bag on flat hard surface (such as a table or workbench) and slowly passing the vacuum nozzle over the entire surface area.
5. Re-install the bag and re-attach the clamp.

Note: Filter bags can also be machined washed (gentle cycle only) in cold or warm water. (Do not use hot water) Do not use detergent. Make sure the bag has completely dried before re-installing on the machine.



FOR MACHINE WASHING, MAKE SURE TO REMOVE THE BELT CLAMP FROM THE BAG BEFORE WASHING!

CLEANING OR REPLACING THE CANISTER FILTER (10-105CF M1/10-105CF DAS M1)



TURN THE SWITCH TO THE “OFF” POSITION AND UNPLUG THE UNIT FROM THE POWER SOURCE BEFORE CLEANING OR REPLACING CANISTER FILTER OR BEFORE PERFORMING ANY MAINTENANCE.

After a period of time depending on the frequency of use, the canister filter may become clogged and affect air-flow as well the overall efficiency of the unit. Should you notice a drop in the efficiency or performance of the unit, it may be a sign that it is time to clean the filters. If so, proceed as follows:

1. Turn off and unplug the machine.
2. For basic cleaning, simply rotate the handle on the top of the canister several rotations. The internal flap will rub against the corrugated inner filter and shake free any built-up dust from inside the filter.
3. For a more thorough cleaning, after rotating the handle, remove the hex nuts and remove the canister from the machine and place it on the ground upside down.
4. Vacuum the inside of the canister to remove any remaining dust from inside.
5. Re-install the canister and re-attach the bolts.

CLEANING OR REPLACING THE COLLECTOR BAG



TURN THE SWITCH TO THE “OFF” POSITION AND UNPLUG THE UNIT FROM THE POWER SOURCE BEFORE CLEANING OR REPLACING COLLECTOR BAG OR BEFORE PERFORMING ANY MAINTENANCE.

Note: Depending on your needs, shop situation and local regulations, collections bags can be emptied and re-used or disposed of (with their contents) and replaced with a new bag.

1. Disconnect the machine from the power source outlet.
2. Remove the collector bag by pushing the ring of the collector bag upwards at an angle and pulling the bag and snap ring out.
3. Empty the contents into an appropriate container.

To replace the collector bag, refer to the Collector Bag Installation on page 10.

RECOMMENDED OPTIONAL ACCESSORIES

We offer a large variety of products for increased convenience, productivity, accuracy and safety when using your dust collector. Here's a small sampling of optional accessories available from your local General International dealer.

For more information about our products, please visit our website at
www.general.ca / www.generaltoolsusa.com



1 Micron Canister Filter
#10-106M

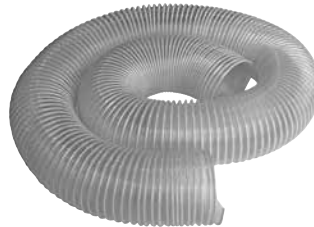

4\"/>



4\"/>



Clear Plastic
Collector Bag
#10-120



2 Micron Filter Bag
#10-115

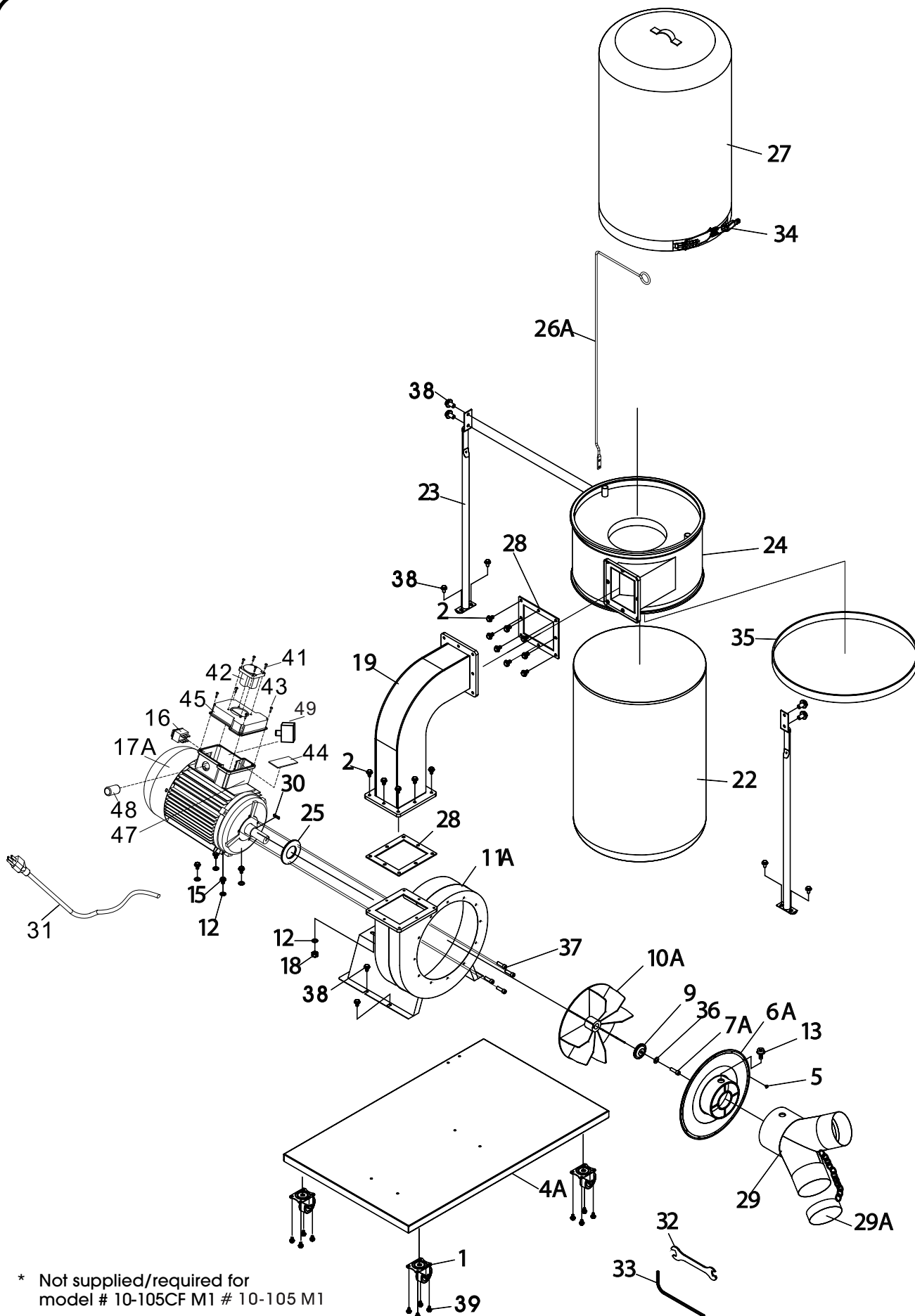

* Not supplied/required for
model # 10-105CF M1 # 10-105 M1

PARTS LIST

NO	PART NO.	DESCRIPTION	SPECIFICATION	QTY
1	10105-01	Caster		4
2	10105-02	Hex.head bolt	5/16"×1/2"L	40
4A	10105-04A	Base plate		1
5	10105-05	Pan head screw	3/16"×3/8"L	12
6A	10105-06A	Inlet cover		1
7A	10105-07A	Cap screw	M6×16MM L	1
9	10105-09	Washer		1
10A	10105-10A	Fan		1
11A	10105-11A	Collector body		1
12	10105-12	Washer	5/16"	8
13	10105-13	Pan head screw	3/16"×3/8"L	1
15	10105-14	Hex.head bolt	5/16"×1"L	4
17A	10105-17A	Motor		1
18	10105-18	Nut	5/16"	4
19	10105-19	Connector		1
22	10105-22	Collector bag		1
23	10105-23	Vertical support rod		2
24	10105-24	Drum		1
25	10105-25	Gasket		1
26A	10105-26A	Hanger		1
27	10105-27	Filter		1
28	10105-28	Foam gasket		2
29	10105-29	Hose inlet("y"fitting)		1
29A	10105-29A	Cap		1
30	10105-30	Key	5MM×40MM	1
31	10105-31	Power cord		1
32	10105-32	Open end wrench	13×10	1
33	10105-33	Hex.wrench		1
34	10105-34	Belt clamp		1
35	10105-35	Snap ring		1
36	10105-36	Lock washer	1/4"	1
37	10105-37	Hex.head bolt	3/8"×1"L	4
38	10105-38	Hex.head bolt	5/16"×2/3"L	12
39	10105-39	Pan head screw	3/16"×1/2"L	16
41	10105-41	Pan head screw		4
42	10105-42	Automatic socket-outlet		1
43	10105-43	Pan head screw	ST2.9×12	4
44	10105-44	Circuit board		1
45	10105-45	Switch box A		1
46	10105-46	On/off switch with automatic function		1
47	10105-47	Switch box B		1
48	10105-48	Fastener		1
49	10105-49	Over-current protector		1

*Not supplied/required for Model #10-105CF M1

**Filter bag #10-115 for model 10-105 or Canister filter #10-106M for model 10-105CF.

IMPORTANT: When ordering replacement parts, always give the model number, serial number of the machine and part number. Also a brief description of each item and quantity desired.

**Canister supplied on Model
#10-105CF DAS M1**

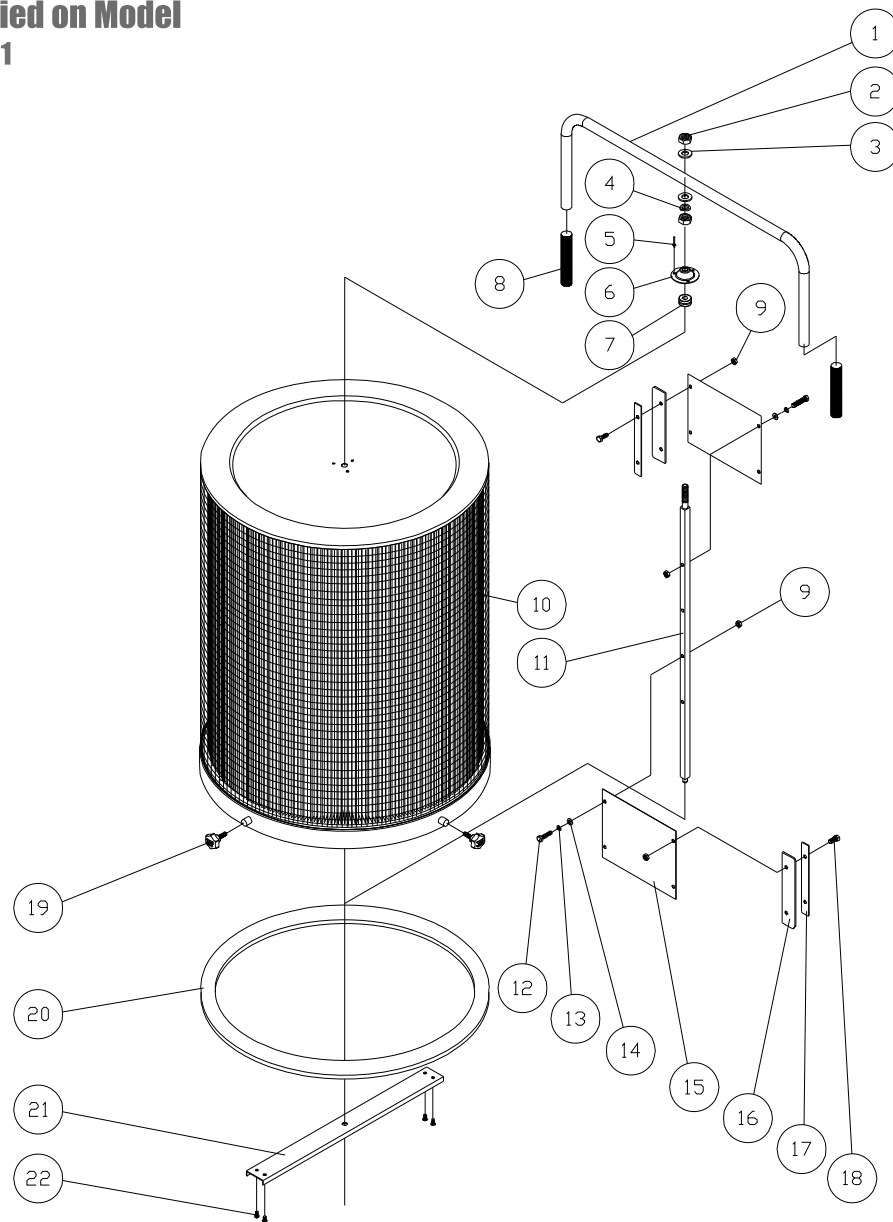

**PARTS LIST
#10-106M**

PART NO.	DESCRIPTION	SPECIFICATIONS	QTY	PART NO.	DESCRIPTION	SPECIFICATIONS	QTY
10-106C-1	Handle		1	10-106C-12	Hex Cap Screw	M6X20	4
10-106C-2	Hex Nut	M10	2	10-106C-13	Lock Washer	M6	4
10-106C-3	Flat Washer	M10	2	10-106C-14	Flat Washer	M6	4
10-106C-4	Lock Washer	M10	1	10-106C-15	Scraper		2
10-106C-5	Rivet	5-2	3	10-106C-16	Strip		2
10-106C-6	Bracket		1	10-106C-17	Press Plate		2
10-106C-7	Pad		1	10-106C-18	Hex Cap Screw	M6x12	4
10-106C-8	Soft Grip Handle		2	10-106C-19	Knob		4
10-106C-9	Hex Nut	M6	8	10-106C-20	Pad		1
10-106C-10	Filter		1	10-106C-21	Support		1
10-106C-11	Shaft		1	10-106C-22	Tapping Screw	M4x8	4

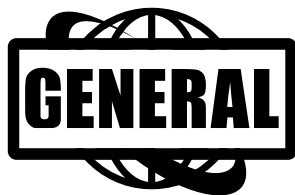

GENERAL INTERNATIONAL POWER PRODUCTS LLC
6243 Industrial Parkway | Whitehouse, Ohio 43571 (USA)

Follow us:

